

FARMS OF WESTERN LANCASTER COUNTY, PENNSYLVANIA: 1710-1750

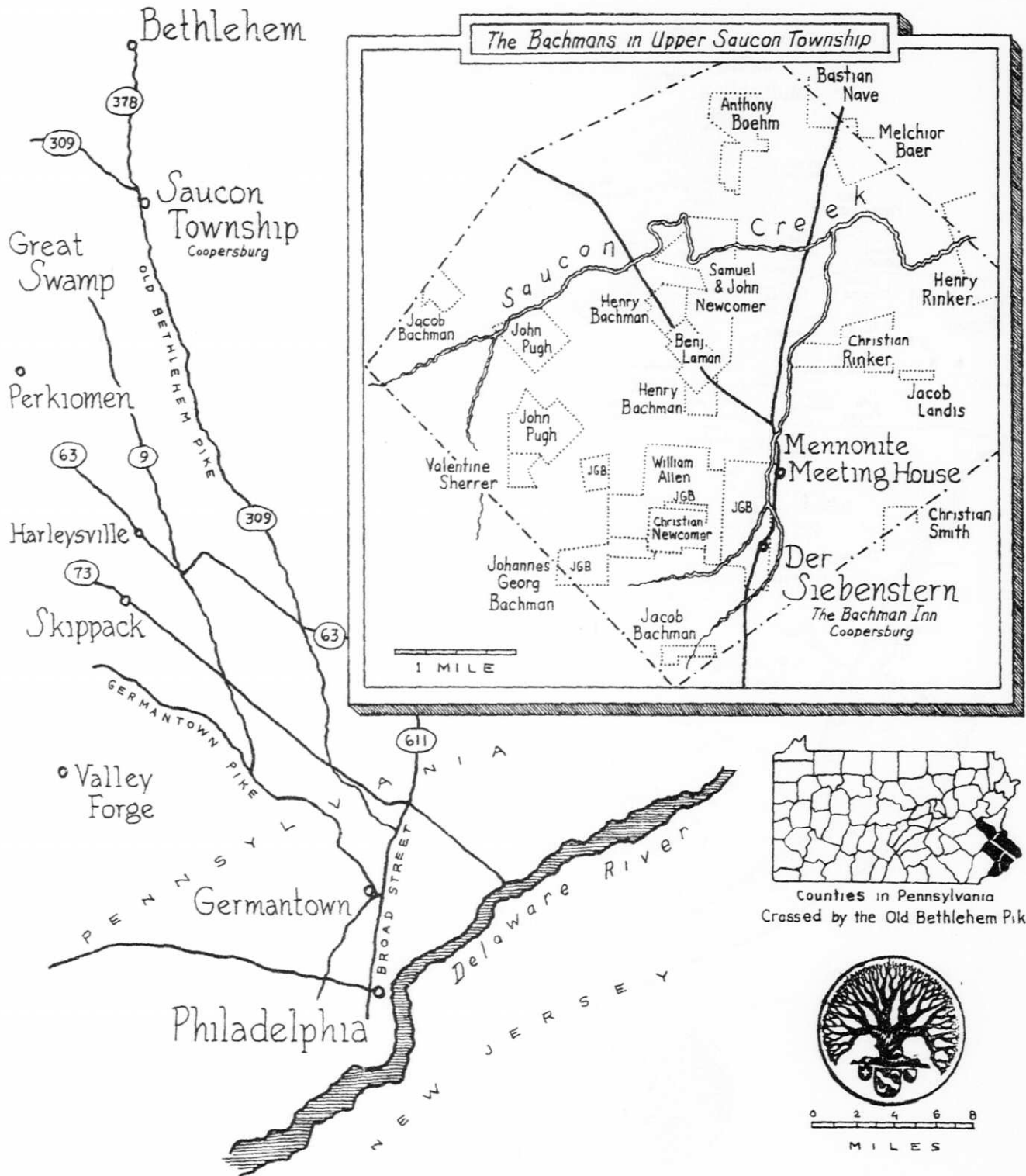

SOME MENNONITE SETTLEMENTS NORTH OF PHILADELPHIA, PENNSYLVANIA: 1710-1750

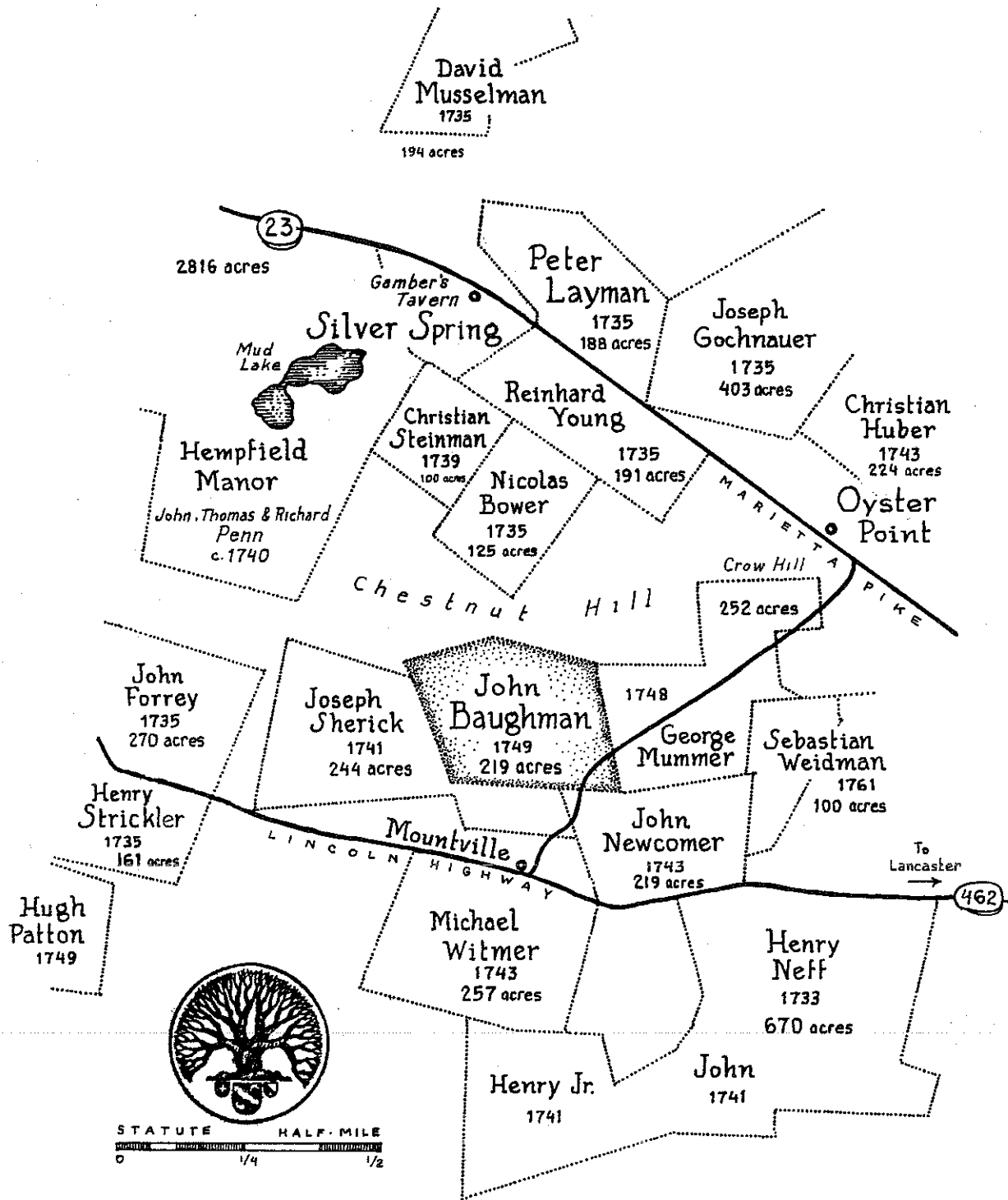

A PART OF HEMPSTEAD TOWNSHIP, AS KNOWN TO THE SWISS AND GERMAN SETTLERS IN 1750
LIVING IN WESTERN LANCASTER COUNTY, PENNSYLVANIA

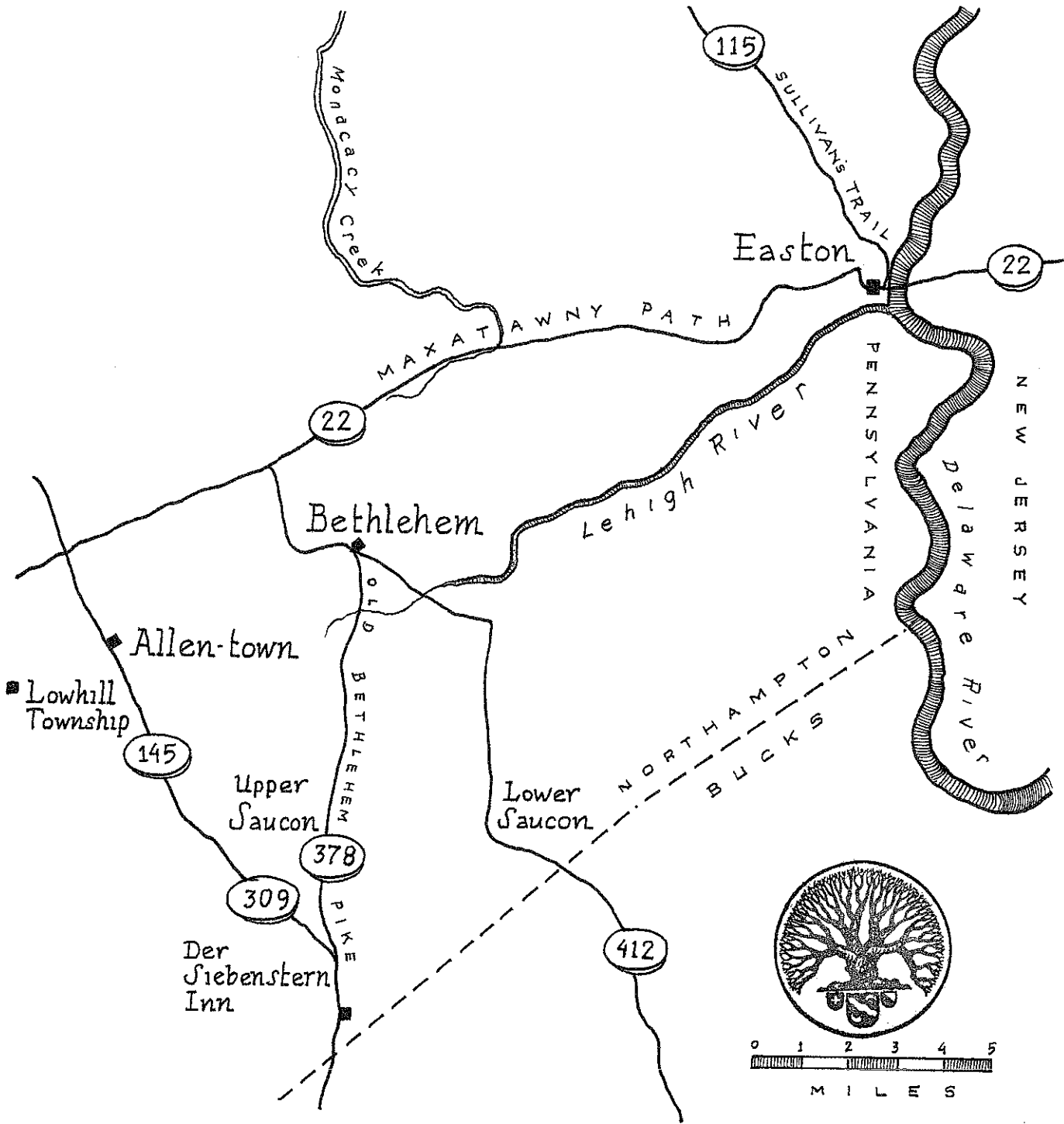

THE PRINCIPLE TOWNS OF NORTHAMPTON COUNTY IN EASTERN PENNSYLVANIA DURING THE FRENCH & INDIAN WAR

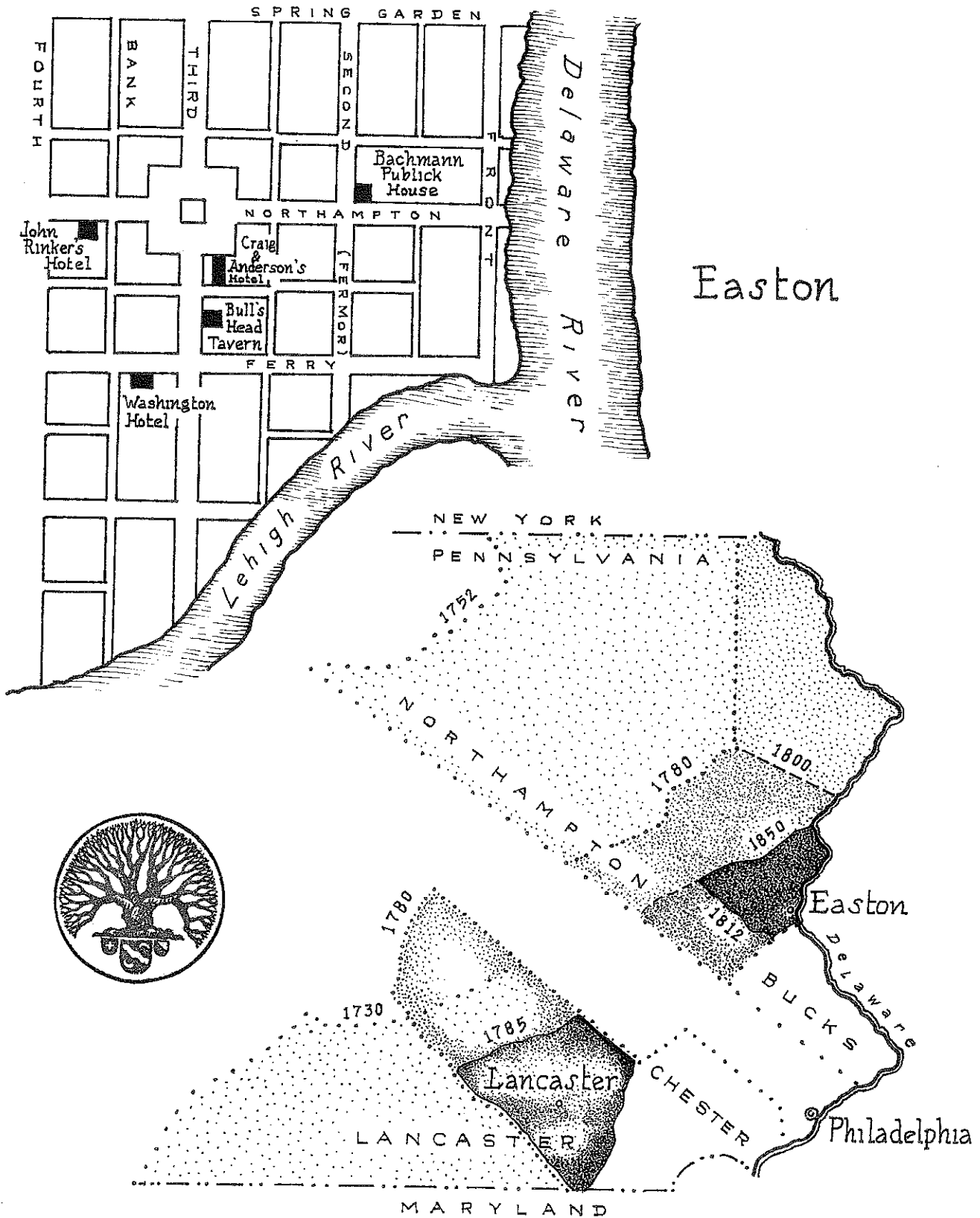

THE TAVERNS AND HOTELS OF EASTON, PENNSYLVANIA DURING THE MID-18TH CENTURY;
ALONG WITH BOUNDARY LINES OF NORTHAMPTON AND LANCASTER COUNTIES DURING THEIR SUBDIVISION

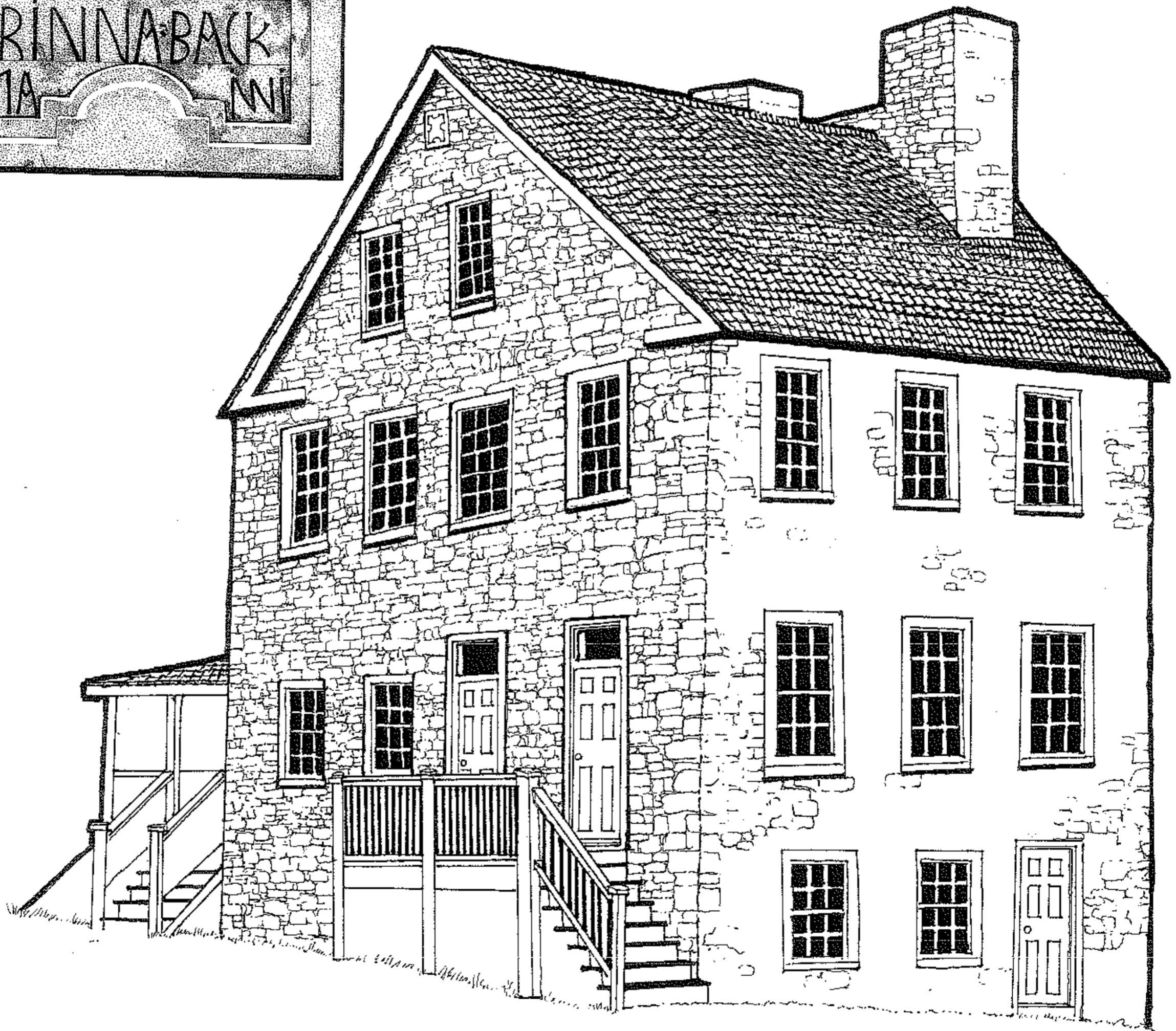

THE BACHMANN PUBLICK HOUSE OF EASTON, PENNSYLVANIA
AS IT APPEARED IN 1753 WHEN A MARKER STONE WAS ADDED NEAR THE ROOF